

The cover joints are specifically designed to protect the mid span joint, made at the "tensioner station", during conductor stringing operations.

The cover joints consist of two shells made of galvanised steel with shaped ends to house the rubber noses, which protect the mid span joint during the passage over the pulleys.

The shells are coupled together by socket screws and the rubber noses are clipped together by belts



Model	Application	ch max	L max	Mass max	Breaking load (at the edges) [kN]
		[mm]	[mm]	[kg]	
PGC	For pulley with 54 mm groove	28	450	12	20
PGS	For pulley with 68 mm groove	37	800	15	20
PGL	For pulley with 95 mm groove	56	1250	23	20

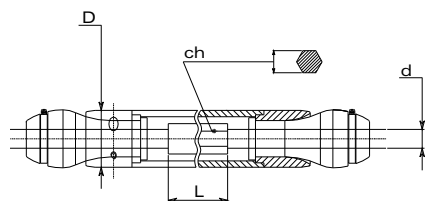

Specify the following data on the order:

- 1) **L** = joint length after compression
- 2) **d** = conductor diameter
- 3) **ch** = the hexagon dimension of mid span joint after compression

THERMOMETERS Mod. TET

The thermometers are made of an aluminium bulb that reproduces the conductor's surface



GENERAL CHARACTERISTICS

Mass (indicative)	0.6 ÷ 1 kg
Length	0.58 m

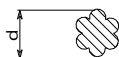

Specify the diameter "d" of the conductor on the order